

HAYAATH NAGAR

PLAN SHOWING THE PROPOSED LAYOUT OF IN SURVEY NO. 569/3. 570/1.2A & 2B,
PADAPPAL VILLAGE, KUNDRATHUR TALUK, KANCHEEPURAM DISTRICT.
WITHN KUNDRATHUR PANCHAYAT PANCHAYAT UNION LIMITS.

LAY OUT WAS APPROVED VIDE NO. LP/DTCP CR APPROVED
NO. 744/90/ROC NO.3779/90, A4

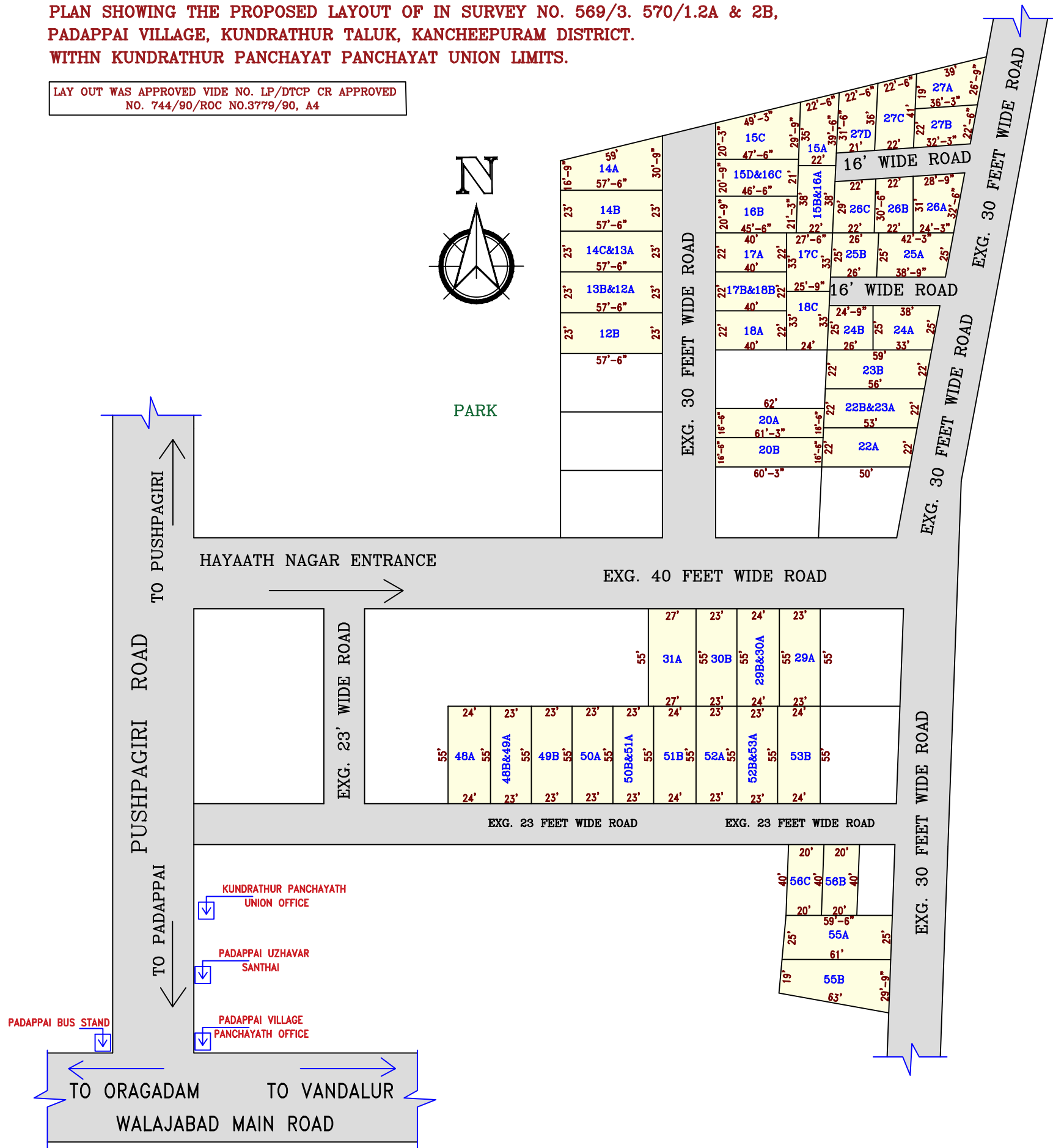

SL.No	PLOT Nos.	AREA IN Sq.Fts.
1	12B	1322
2	13B&12A	1322
3	14C&13A	1322
4	14B	1322
5	14A	1404
6	15A	829
7	15B&16A	836
8	15C	1210
9	15D&16C	981
10	16B	989
11	17A	880
12	17B&18B	880
13	18A	880
14	17C	879
15	18C	821
16	20A	1017
17	20B	1000
18	22A	1133
19	22B&23A	1199
20	23B	1265
21	24A	888
22	24B	634
23	25A	1013
24	25B	650
25	26A	841
26	26B	678
27	26C	655
28	27A	861
29	27B	762
30	27C	854
31	27D	734
32	29A	1265
33	29B&30A	1320
34	30B	1265
35	31A	1485
36	48A	1320
37	48B&49A	1265
38	49B	1265
39	50A	1265
40	50B&51A	1265
41	51B	1320
42	52A	1265
43	52B&53A	1265
44	53B	1320
45	55A	1509
46	55B	1515
47	56B	800
48	56C	800